

DIGITAL
CINEMA

AVAILABLE AT
DIGITAL CINEMA

Installation and manual of frame screen/curve frame screen



[Attention] Please read this manual before installing and using the projection screen, and retain this manual for future reference.

Installation

Important safety tips

Warning Please strictly comply with the following safety rules, wrong installation or using methods will bring damage to machinery or personnel injury.

Considerations for installing/ using this product

1. Please handle with care.
2. Don't expose it in the rain and keep away from water.
3. Keep away from fire/heat.
4. Please don't fold or scratch the screen.
5. Please distinguish the front/back side while installing.
6. Ensure the screen to be installed in a horizontal position.

A Please follow the manual to operate.
A Please contact professional services staff for installation and maintenance.

- For any fault of installation or operation, we do not assume compensation liability for any mechanical damage or casualties.

Cleanning

Please use dry and soft cloth with non - corrosive components and neutral soap water to clean the screen and the shell carefully. Do not use chemicals or corrosive materials, or it will damage the product.

Installation

Check the list of items

Our company reserves the right to the accessories contained in the manual, and we are subject to change without notice.

- Installation manual(1 copy)
- Warranty card(1 copy)
- Reminder stickers(1 copy)
- Accessories bag(3 copies)

— frame borders — screens - - fiberglass poles

General Accessories



Connected plate



Spring hook



Philips screwdrivers



PVC poles



Sleeve anchors
Tapping screw



Swell plastic button



M5 screw



Spring

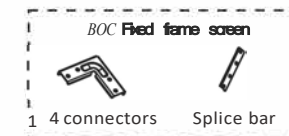
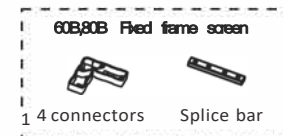

Installation

Step 1: Take out the product

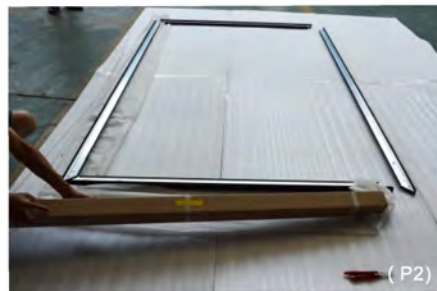

1.1 Take out the inner packing which contains the frame, and put them onto clean table or floor.

1.2 Take the frame out of the inner packing, and then put them back side up as picture 3.

1.3 Take the accessories out of the accessory bag.

Step 2: Connect the frame(if needed)

some frames are cut into several parts because they are overlong or specially designed, so they need to be connected. If it is not cut, this step can be skipped.



2.1 Insert the splice bar into the frame, then tighten the screws, so the frame has been connected as picture 4. (The picture shows the connecting method of BOC. The methods of 60B, 80B and 100B are similar.)

Installation

Step 3: Connect the connector

Note: Please refer to the following connecting method according to the standard and type of your product.

Connector connecting method of 60B and 80B (Picture 6A - 8A)

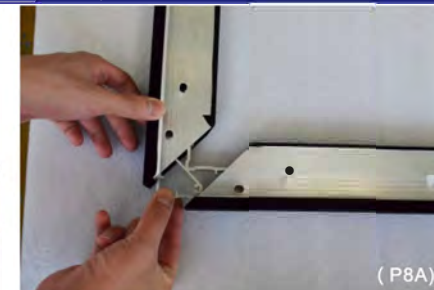

3.1 A Take out the connector (please note that the side with taps should be upward). Insert the connector into the frame; connect the frame, put a screw into the corresponding hole position of the connector and screw it half tight. Your hand should hold the frames tightly and make the horizontal frame and vertical frame stay closely as picture 7A - 9A.

Connector connecting method of 80C (Picture 6B - 8B)

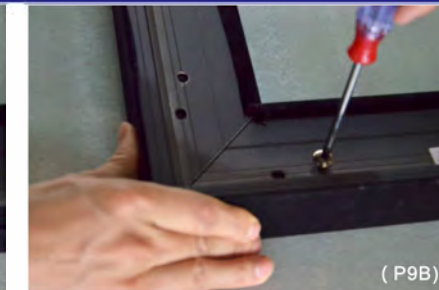
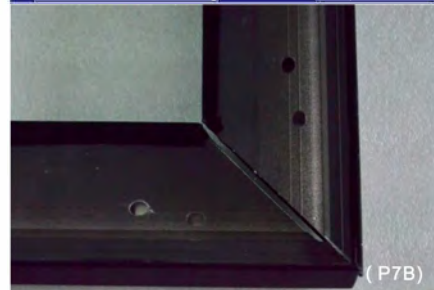

3.1 B Place the horizontal and vertical frame properly. Insert the connector into the frame; connect the frame, put a screw into the corresponding hole position of the connector and screw it half tight. Your hand should hold the frames tightly and make the horizontal frame and vertical frame stay closely as picture 7B - 9B.

Intallation

Connector connecting method of 100B (Picture 4C, 5C, 6C)

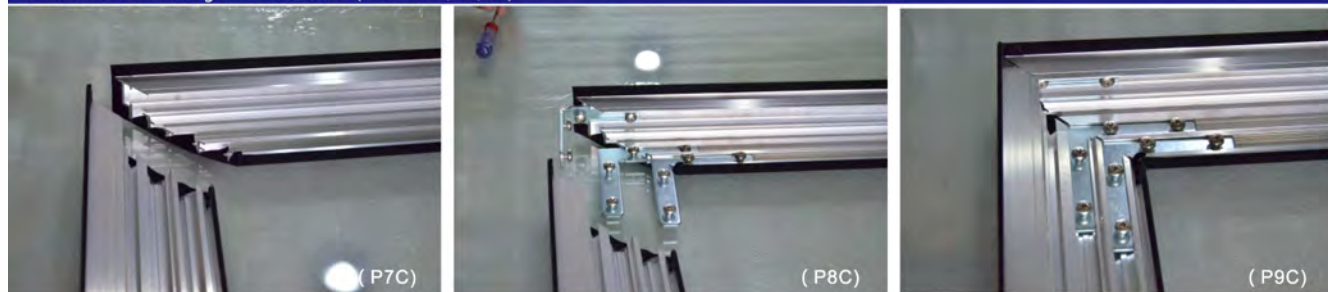

3.1 C Place the horizontal and vertical frame properly. Insert the connector into the frame; connect the frame, put a screw into the corresponding hole position of the connector and screw it half tight. Your hand should hold the frames tightly and make the horizontal frame and vertical frame stay closely as picture 7C - 9C.



3.2 After installing the connector, check the four corners and see whether it is tightly connected. If there is no gap, please tighten all the screw as picture 10.

3.3 If it is a curved screen, you'd better use a strut to support it to prevent deformation.

Intallation

Step 4: Unfold the screen



9. Take out the screen (distinguish the front and back side, the front side should be downward.) Put it in the center of the frame and unfold it as picture 12 - 14.

Install the PVC poles



10. Put four PVC poles into the edgefolds at four sides of the screen, expose 2-3cm as picture 14-16.

Installation

Step 6: Install strut bar(if needed)

Some screens are equipped with strut bar. Please install it according to the following steps.



6.1 The hole position of the strut bar must exactly align to the hole position of the frame, and then tighten a screw.

Step 7: Install the spring



7.1 Hook one end of the spring slot to the frame slot, then use a wire retractor to hook the other end of the spring to the PVC pole. The correct order is: hook the 8 springs of the four corners first, and then hook the others.

7.2 After finishing the above steps, then installation is completed as picture 22.

Installation

Step 8: Installation on the wall

A:1. Installaion of the frame screen;Install the curve frame screen on the curve wall.

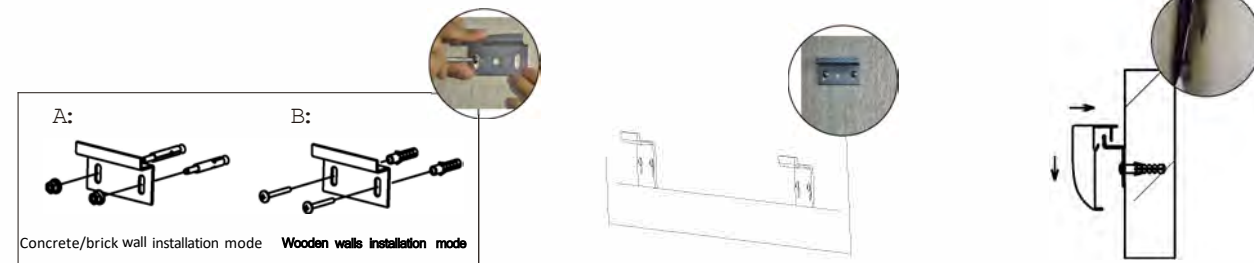

1. According to the quantity of the connected plates and appropriate distance, you should install the connected plates on the suitable area on the wall with screws.

2. Hang the frame screen on the on the wall.

3. Finished.

2. Install the lower connected plate if necessary(If you need to fix the screen or find that the bottom of the screen does not fit closely with the wall, please follow the steps below.)

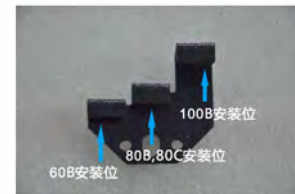

1. Take out the lower connected plate(Please note the mounting position of the product.)



2. Gently lift the bottom of the screen, use the lover connected plate to hook the slot position of the frame.



3. Tighten a screw and installation completed.

Installation

B: Install the curve frame screen on the plane wall or curve wall.

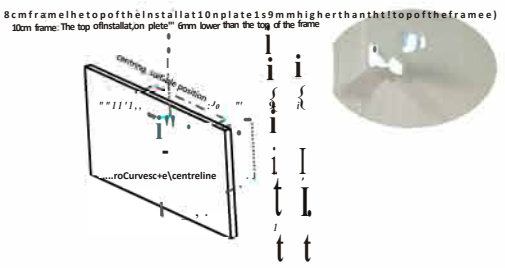

1. Install the Installation plates on the wall as the picture.

2. Insert the connected plate into the upper Installation plate.

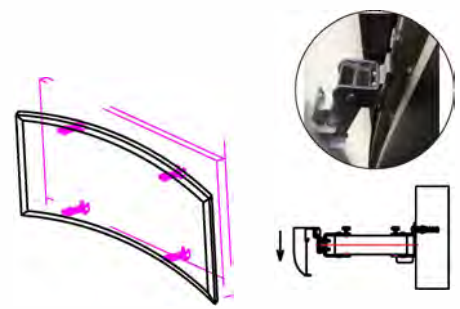

3. The screen frame is inserted into the socket of the connected plates.

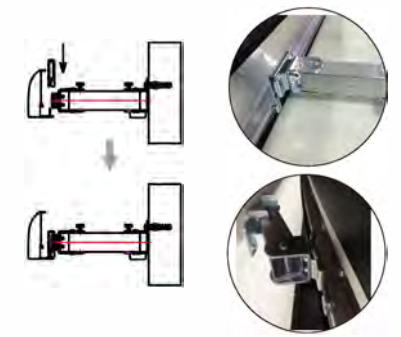

4. Adjust the rotation angle of frame and Installation plates, and insert the lower connected plate into the socket of Installation plates.

Installation

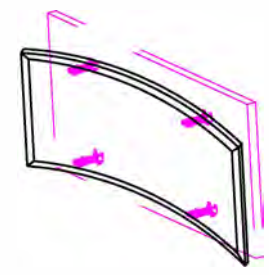

5. Push the screen frame, rotate the Installation plates, slide the upper and lower connected plates, then adjust the frame screen to the suitable position.

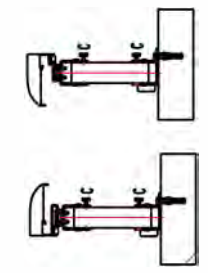

6. Screw the hand screw lightly, fix the frame screen.